

User Manual-Solar DC System

Thank you for buying our portable solar DC system. Please read user manual carefully before using and use under instruction. For safety of you and others, manual instruction must be followed.

1. Characteristic

- 1) No need for city power;
- 2) Effectively take advantage of natural power resource;
- 3) Safe,environment friendly and portable;
- 4) More suitable for place without city power;
- 5) Long working time;
- 6) High safety lamp made of no thermal and less wastage material;
- 7) Support mobile phone and PSP etc charging;

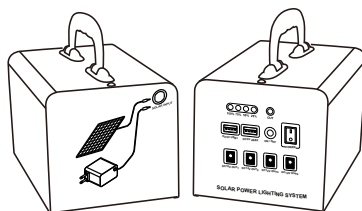

2. Product appearance: (Picture on the right)

3. Using method

3-1. Lamp using method

- 1) Special LED lamp is provided. Connect lamp cable to any port of front DC12V OUT1---DC12V OUT4, turn on main switch and then output switch. Some models have no output switch, so only turning on main switch is ok. LED lamp is special and do not use from other suppliers.

3-2. Solar charging method

- 1) Please put solar panel in place under good sunshine.
- 2) Connect solar panel cable to SOLAR IN port, and turn on main switch to start charging.
- 3) Please turn off main switch when don't use.

3-3.Mobile phone charging method

- 1) This system support all kinds of mobile phone charging.
- 2) Connect phone USB cable to system USB port DC5V USB for charging.

3-4.Small game console and other products charging method

- 1) For DS and PSP etc, switch off power and connect to USB port directly. Please notice that USB voltage is same with above product.

4. Connecting diagram

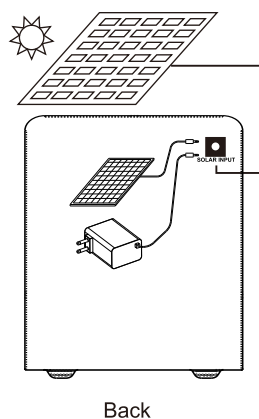
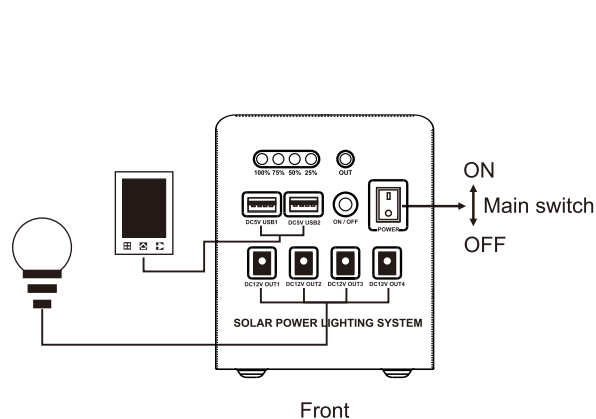

5. Maintenance

- 1) Product surface can be cleaned with soft cloth but water or detergent must be avoided into product inside.
- 2) Please do not put product in high temperature, wet and dust place when long time no use.
- 3) Battery replacing
 - Firstly turn off main switch
 - Pull out solar panel cable
 - Loosen screws on product
 - Pull out battery cable and replace battery
 - Pay attention that battery cable correctly connects positive and negative polarity.

6.System cabinet:

Model:XD	T107	T207	T307	T1012	T2012	T3012
Solar panel	10W	20W	30W	10W	20W	30W
Battery	12V-7AH	12V-7AH	12V-7AH	12V-12AH	12V-12AH	12V-12AH
Accessory	4pcs 3W/LED lamps, 1pcs Multi function phone charging cable, 4pcs LED cables, 1pcs AC adapter charger					
Packing	245x240x160mm(1pc) / 756x255x340mm(6pcs)					

7. Output port

1) Protection

DC 12V OUT1 - DC 12V OUT4 Output current 0.75A, blinking when over current, shutting up whenever 1.5 times or in short circuit.

USB1 USB2 Output current 1A, shutting up when over, restart automatically when back normal.

8. Flash according to battery voltage decreasing when no solar power input:

100%	12.5V
75%	12V
50%	11V
25%	10.5V(<25% blinking slowly)
0%	9.8V(blinking fast)

9. Blinking as horse race lamp when charging:

100%	14.50V
75%	13.75V
50%	13.35V
25%	13.00V
0%	<12.50V

10. General false and resolution

General false	Reason	Resolution
Battery capacity signal lamp doesn't flash	Electronics switch damage	Replace electronics switch
Output shut up repeatedly	Too many electronics load	Reduce electronics load
	Solar power insufficient	Use after battery full charging
Working time shorten	Charging insufficiently or over discharging	Use after full charging or discharge properly
	Battery damage	Replace battery
Battery charging failing	Solar panel improper connection	Pull out and connect again